

USE AND SETTING INDICATION

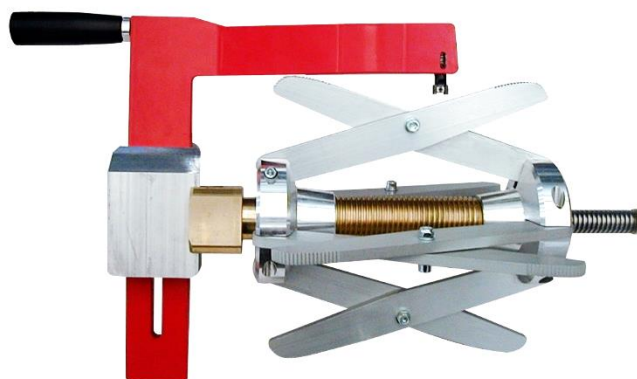

INTRODUCTION

Users are reminded that they should ensure:



- Operatives are adequately trained and provided with safe working procedures.
- Equipment is properly maintained in accordance with the manufacturers recommendations.

DESCRIPTION

The **SCR 400** is a mechanical rotating pipe scraper for PE and other thermoplastic materials pipes and fittings that guarantees to get pipes and fittings surfaces prepared before the electrofusion procedure by removing the oxide layer of the external surface. The working range goes from Ø 200 mm up to Ø 400 mm.

Below description of the several components and parts of the tool:

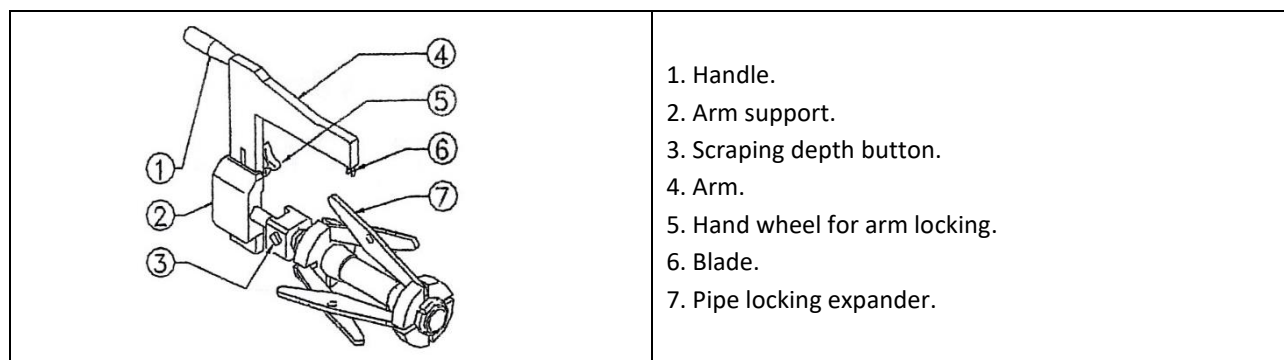

TECHNICAL FEATURES

Welding range	Ø 200 ÷ 400 mm
Dimension	500 x 350 x 170 mm
Weight	6 Kg
Blade width	0,4 mm
Scraping depth	0,2 mm
Scraping length	210 mm

SETTING

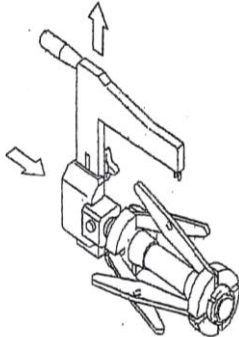
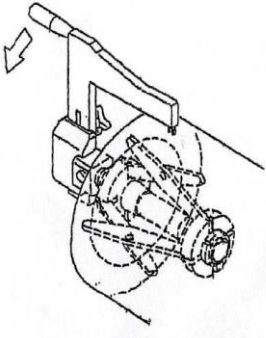
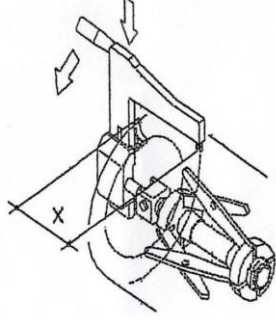
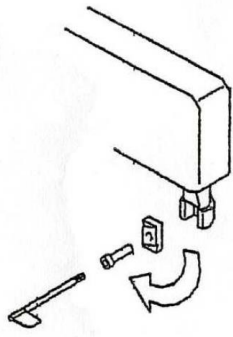
	<p>Make sure that the arm 4 is in the top position before starting any operations. Pushing the button 3 the support 2 should be into the housing of the scraper body.</p>
	<p>Now it is possible to lock the tool into the pipe by handling the handle 1 and turning the scraper clockwise.</p> <p>The operation will make the expander blades 7 open until they get in touch with the pipe.</p>
	<p>Unlock the arm from the main body by pushing the button 3 and adjusting the scraping depth "X".</p> <p>Depress the arm 4 down and lock it with the hand wheel 5 in order to load the blade on the pipe.</p> <p>Then proceed by scraping the end of the pipe.</p> <p>Keep the handle 1 firmly and turn the body constantly clockwise.</p>
	<p>The blade 6 can be turned in order to use the second sharp. Otherwise, it can be replaced unscrewing it with the supplied service key.</p> <p>The blade durability changes depending on the intensity of use and environmental conditions.</p>